

November 19-20, 2009 | Gaylord National Hotel | National Harbor, MD



OREUG
Oracle Real Estate Users Group

Real Estate User Group Meeting Table of Contents

General Conference Information	02
Hotel Maps	03
Meeting Agenda	04
Exhibitor Information	06
Exhibitor Showcase Map	07

Presented in partnership:



GENERAL INFORMATION

Badges

Everyone must wear a badge to attend all conference functions. Please keep your badge visible at all times. Lost badges should be turned in and retrieved at the registration area.

Message Board

A message board with updates on each day's events will be available by the registration desk, where you can also post or retrieve messages for other attendees.

Business Center

Gaylord National provides you an office away from the office. The full-service 11th Hour Technology Center is centrally located on the main floor of the Convention Center. Shipping, faxing, copying and office equipment rentals are right at hand. And, you'll never have to leave the hotel to take care of your documentation needs, including large document reproduction, offset printing and bindery services.

For last-minute changes or projects, the business center offers 24-hour self-service printing and copying.

Business Center: (301) 965-2030
Business Center fax: (301) 965-2039
Parcel receiving: (301) 965-2031
Parcel receiving fax: (301) 965-2038

Hours of Operations:

- Open every day, 7:00 AM to 9:00 PM
- 24-hour Internet Access
- 24-hour Self-service Printing and Copying

Conference Evaluations

The Real Estate team will be sending out an online survey immediately following the conference. Be sure to look for this in your inbox -- your feedback helps us improve the conference from year to year.

Lost and Found

Please return all lost items, other than conference badges, to the hotel front desk. Badges can be turned in at the registration/information desk

Photography and Videography

By attending the Circuit conference, all attendees hereby irrevocably consent to and authorized the use by Quest and its assignees and licensees, of any and all photographs and video images taken. This includes any reproduction of the images in any form in any media whatsoever.

Finding your way around

Use the following maps to navigate your way through the Gaylord National Hotel and Convention Center.

Hotel - Conference Level

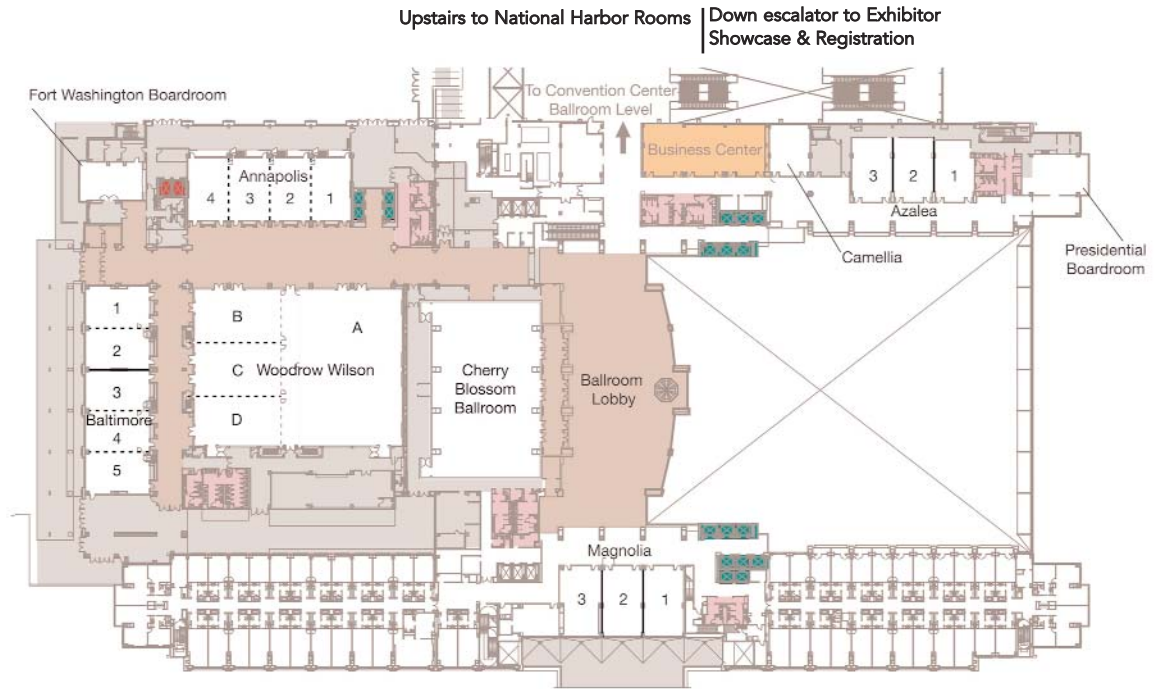

Convention Center - Exhibitor Hall Level

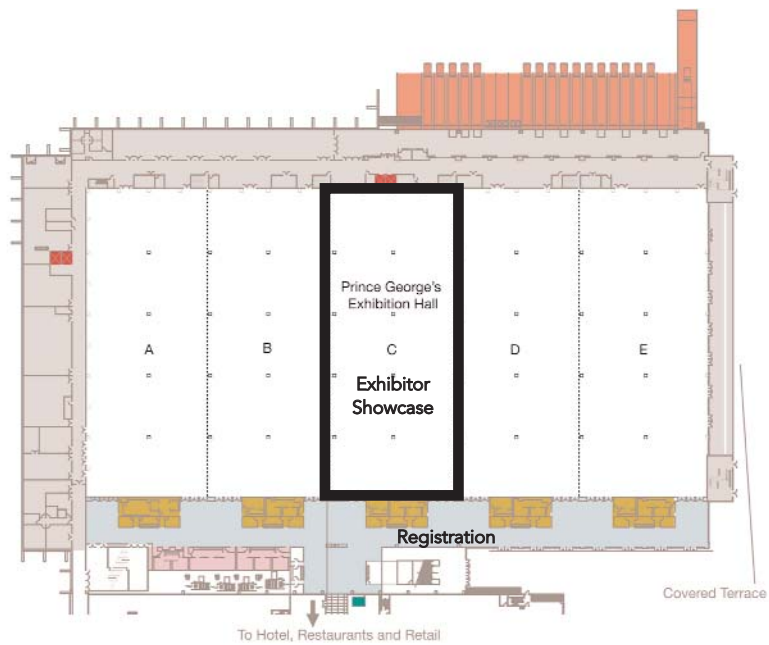

Real Estate User Group Meeting 2009 I Agenda

Wednesday

5:30 PM – 6:30 PM **Welcome Networking Reception**
Sponsored by Oracle
Annapolis 2 & 3



Thursday

7:30 AM - 9:00 AM **Continental Networking Breakfast**
Join the Circuit Conference Attendees in the Exhibitor Showcase for nextworking and sharing.
Prince George's Exhibition Hall C

9:00 AM - 9:15 AM **Welcome**
Dave Hyzy, OREUG President
National Harbor 4

9:15 AM - 9:30 AM **Quest Introduction**
Sue Shaw, Quest President
National Harbor 4

9:30 AM - 10:15 AM **Company Introductions**
National Harbor 4

10:15 AM - NOON **Oracle Update**
Wade Job, Kevin Van Horn and Brian Hicks
National Harbor 4

NOON – 1:00 PM **Lunch**
Sponsored by InsightSoftware.com
(Formerly The GL Company)
National Harbor 4



1:00 PM – 2:15 PM **1st Roundtable Session**
Workflow - Discussions from companies on use of workflow from multiple solution providers.
Steve Whitton, Benderson and Shane McConnel, Centro Properties Group
National Harbor 4

Oracle Expense Participation Update - With Oracle's 9.0 version are there compelling reasons and functionality enhancements that make Expense Participation attractive?
Ada Bakogianis, Palazzo, Inc. and Bob Ciborowski, Softserve
National Harbor 5

Intranet/Portals - Discussion on how people are using portals and intranets such at Websphere and SharePoint.
Craig Scullin, Granite Properties
National Harbor 6

2:15 PM – 3:30 PM **2nd Roundtable Session**
Accounts Payable - Making your AP group more efficient. Invoice imaging with workflow, credit card payment process, ETF
Tim Mueller, Highwoods Properties
National Harbor 4

Oracle AREF Update - With Oracle 9.0 version are there compelling reasons and functionality enhancements that make AREF attractive?
Helane Stein, PREIT
National Harbor 5
CRM - There are many solutions for CRM (Oracle, Microsoft,

Real Estate User Group Meeting 2009 I Agenda

- Sales Logics, Salesforce.com...) This session will explore how JD Edwards is being used or leveraged to enhance CRM.
*Craig Scullin, Granite Properties
 National Harbor 6*
- 3:30 PM – 3:45 PM** **Break**
National Harbor 4 Foyer
- 3:45 PM – 5:30 PM** **Customer Show and Tell**
National Harbor 4
- This will be an interactive discussion where members of the group share what they are doing with technology. This is an opportunity for each company to share what they are most proud of and to see what their peers are doing. Topics for this session include:
- Reporting AD Hoc - Centro Properties Group
 - Bland Data Warehouse – Granite Properties, Benderson and, Health Care REIT
 - Document Management –Highwoods Properties and Benderson
- 5:40 PM – 7:10 PM** **Reception in Exhibitor Showcase**
Prince George's Exhibition Hall C
- 7:10 PM – 9:00 PM** **OREUG Dinner**
 Sponsored by Oracle
Woodrow Wilson D
-
- Friday**
-
- 8:00 AM – 8:45 AM** **Continental Breakfast**
National Harbor 4 Foyer
- 8:45 AM – 10:00 AM** **3rd Roundtable Session**
 Automate Tenant Statements - Going green and using email to tenant statements or other ways to automate.
*Rohit Gupta, Health Care REIT, Inc.
 National Harbor 4*
- Auto-Cash Apply - Getting the most cash receipts to match and how to make the most out of this process.
*Bob Ciborowski, Softserve
 National Harbor 5*
- Oracle Upgrade Experiences - Discussions from companies how recent version upgrades and challenges they faced.
 Dave Pigott, Boston Properties and Helane Stein, PREIT
National Harbor 6
- 10:00 AM – 10:15 AM** **Break**
National Harbor 4 Foyer
- 10:15 AM – 11:30 AM** **Enhancement Session - Oracle Real Estate Enhancements**
 A group discussion where the OREUG identifies and discusses desired enhancements to the Real Estate application with Oracle and the group.
National Harbor 4
- 11:30 AM – NOON** **Wrap Up/Next Steps**
National Harbor 4
- Q&A
 - Realcomm Social '10
 - COLLABORATE 10

Exhibitor Showcase Hours

Thursday 7:30 AM - 10:40 AM, 11:40 AM - 4:40 AM, and 5:40 PM – 7:10 PM

Real Estate Exhibitors

Global Software - #226
Amy Collier
E-mail: amy.collier@glbsoft.com
Phone: 919.865.5441
www.glbsoft.com

InsightSoftware.com - #107
Russell Johnston
russell.johnston@insightsoftware.com
Phone: 303.872.6950
www.insightsoftware.com

Oracle - #2
Virginia Bart
E-mail: virginia.bart@oracle.com
Phone: 404.310.4005
www.oracle.com

CIRCUIT 2009 | Show Floor Map

